

# Planetary Gearhead GP 19 B $\varnothing 19$ mm, 0.1–0.3 Nm

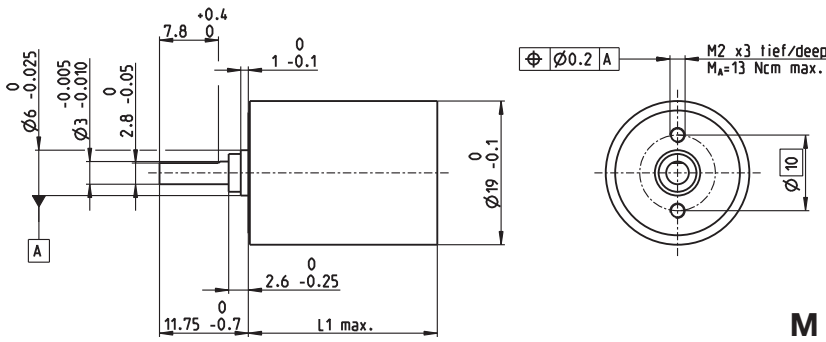

M 1:1

## Technical Data

Planetary Gearhead	straight teeth
Output shaft	stainless steel, hardened
Bearing at output	sleeve bearing
Radial play, 6 mm from flange	max. 0.08 mm
Axial play	0.02–0.12 mm
Max. axial load (dynamic)	8 N
Max. force for press fits	100 N
Direction of rotation, drive to output	=
Max. continuous input speed	8000 rpm
Recommended temperature range	-30...+100°C
Extended range as option	-40...+100°C
Number of stages	1 2 3 4 5
Max. radial load, 6 mm from flange	8 N 12 N 16 N 20 N 20 N

maxon gear

- Stock program
- Standard program
- Special program (on request)

## Part Numbers

	149039	149041	149044	149047	149048	149051	149053	149056
<b>Gearhead Data</b>								
1 Reduction	4.4:1	19:1	84:1	157:1	370:1	690:1	1621:1	3027:1
2 Absolute reduction	57/13	3249/169	185193/2197	19683/125	10556001/28561	1121931/1625	601692057/371293	63950067/21125
3 Max. motor shaft diameter	mm 2	2	2	1.5	2	2	2	2
<b>Part Numbers</b>	149040	149042	149045		149049	149052	149054	149057
1 Reduction	5.4:1	24:1	104:1		455:1	850:1	1996:1	3728:1
2 Absolute reduction	27/5	1539/65	87723/845		500021/10985	531441/625	285012027/142805	30292137/6125
3 Max. motor shaft diameter	mm 1.5	2	2		2	1.5	2	2
<b>Part Numbers</b>		149043	149046		149050		149055	149058
1 Reduction		29:1	128:1		561:1		2458:1	4592:1
2 Absolute reduction		729/25	41553/325		2368521/4225		135005697/54925	14348907/3125
3 Max. motor shaft diameter	mm	1.5	2		2		2	1.5
4 Number of stages		1	2	3	3	4	4	5
5 Max. continuous torque	Nm	0.10	0.15	0.20	0.20	0.25	0.25	0.30
6 Max. intermittent torque at gear output	Nm	0.150	0.225	0.300	0.300	0.375	0.375	0.450
7 Max. efficiency	%	90	81	73	73	65	65	59
8 Weight	g	26	31	36	36	41	41	46
9 Average backlash no load	°	1.4	1.6	2.0	2.0	2.4	2.4	3.0
10 Mass inertia	gcm <sup>2</sup>	0.07	0.05	0.05	0.05	0.05	0.05	0.05
11 Gearhead length L1	mm	15.9	19.5	23.1	23.1	26.7	26.7	30.3



## maxon Modular System

+ Motor	Page	+ Sensor/Brake	Page	Overall length [mm] = Motor length + gearhead length + (sensor/brake) + assembly parts							
A-max 19	197/198			44.9	48.5	52.1	52.1	55.7	55.7	59.3	59.3
A-max 19, 1.5 W	198	MR	388/390	50.0	53.6	57.2	57.2	60.8	60.8	64.4	64.4
A-max 19, 1.5 W	198	Enc 22	398	59.3	62.9	66.5	66.5	70.1	70.1	73.7	73.7
A-max 19, 1.5 W	198	MEnc 13	409	52.4	56.0	59.6	59.6	63.2	63.2	66.8	66.8
A-max 19, 2.5 W	199/200			47.5	51.1	54.7	54.7	58.3	58.3	61.9	61.9
A-max 19, 2.5 W	200	MR	388/390	51.8	55.4	59.0	59.0	62.6	62.6	66.2	66.2
A-max 19, 2.5 W	200	Enc 22	398	61.9	65.5	69.1	69.1	72.7	72.7	76.3	76.3
A-max 19, 2.5 W	200	MEnc 13	409	55.0	58.6	62.2	62.2	65.8	65.8	69.4	69.4

## Option Ball Bearing

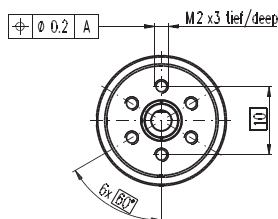

## Part Numbers

4.4 : 1	227632	455 : 1	227642
5.4 : 1	227633	561 : 1	227643
19 : 1	227634	690 : 1	227644
24 : 1	227635	850 : 1	227645
29 : 1	227636	1621 : 1	227646
84 : 1	227637	1996 : 1	227647
104 : 1	227638	2458 : 1	227648
128 : 1	227639	3027 : 1	227649
157 : 1	227640	3728 : 1	227650
370 : 1	227641	4592 : 1	227651

## Technical Data

Planetary Gearhead	straight teeth
Output shaft	stainless steel, hardened
Bearing at output	preloaded ball bearings
Radial play, 6 mm from flange	max. 0.08 mm
Axial play at axial load	< 4 N 0 mm
	> 4 N max. 0.05 mm
Max. axial load (dynamic)	8 N
Max. force for press fits	25 N
Direction of rotation, drive to output	=
Max. continuous input speed	8000 rpm
Recommended temperature range	-40...+100°C
Number of stages	1 2 3 4 5
Max. radial load, 6 mm from flange	10 N 15 N 20 N 20 N 20 N
Gearhead values according to sleeve bearing version	