

# Planetary Gearhead GP 32 HP $\varnothing 32$ mm, 4.0–8.0 Nm

High Power

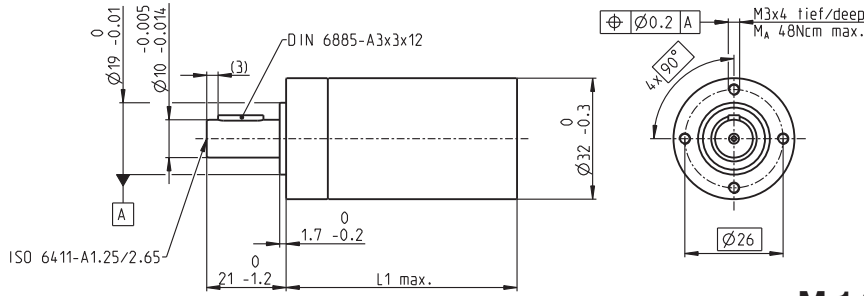

M 1:2

## Technical Data

Planetary Gearhead	straight teeth
Output shaft	stainless steel
Bearing at output	ball bearing
Radial play, 10 mm from flange	max. 0.14 mm
Axial play	max. 0.4 mm
Max. axial load (dynamic)	120 N
Max. force for press fits	120 N
Direction of rotation, drive to output	=
Max. continuous input speed	8000 rpm
Recommended temperature range	-40...+100°C
Number of stages	2 3 4
Max. radial load, 10 mm from flange	200 N 250 N 300 N

maxon gear

- Stock program
- Standard program
- Special program (on request)

## Part Numbers

	320247	326663	326664	326668	326672	324947	324952
<b>Gearhead Data</b>							
1 Reduction	14:1	33:1	51:1	111:1	190:1	456:1	706:1
2 Absolute reduction	676/49	529/16	17576/343	13824/125	456976/2401	89401/196	158171/224
3 Max. motor shaft diameter	mm 6	3	6	4	6	3	3
<b>Part Numbers</b>	326659		326665	326669	324942	324948	324953
1 Reduction	18:1		66:1	123:1	246:1	492:1	762:1
2 Absolute reduction	624/35		16224/245	6877/56	421824/1715	86112/175	19044/25
3 Max. motor shaft diameter	mm 6		6	3	6	6	4
<b>Part Numbers</b>	326660		326666	326670	324944	324949	324954
1 Reduction	21:1		79:1	132:1	295:1	531:1	913:1
2 Absolute reduction	299/14		3887/49	3312/25	101062/343	331776/625	36501/40
3 Max. motor shaft diameter	mm 6		6	4	6	4	3
<b>Part Numbers</b>	326661		326667	326671	324945	324950	
1 Reduction	23:1		86:1	159:1	318:1	589:1	
2 Absolute reduction	576/25		14976/175	1587/10	389376/1225	20631/35	
3 Max. motor shaft diameter	mm 4		6	3	6	6	
<b>Part Numbers</b>	326662		320297		324946	324951	
1 Reduction	28:1		103:1		411:1	636:1	
2 Absolute reduction	138/5		3588/35		359424/875	79488/125	
3 Max. motor shaft diameter	mm 4		6		6	4	
4 Number of stages	2	2	3	3	4	4	4
5 Max. continuous torque	Nm 4	4	8	8	8	8	8
6 Max. intermittent torque at gear output	Nm 6	6	12	12	12	12	12
7 Max. efficiency	% 75	75	70	70	60	60	60
8 Weight	g 178	178	213	213	249	249	249
9 Average backlash no load	° 0.8	0.8	1.0	1.0	1.0	1.0	1.0
10 Mass inertia	gcm <sup>2</sup> 1.6	0.5	1.5	0.7	1.5	1.5	0.7
11 Gearhead length L1	mm 48.3	48.3	55.0	55.0	61.7	61.7	61.7



## maxon Modular System

+ Motor	Page	+ Sensor/Brake	Page	Overall length [mm] = Motor length + gearhead length + (sensor/brake) + assembly parts					
RE 35, 90 W	184			119.4	119.4	126.1	126.1	132.8	132.8
RE 35, 90 W	184	MR	393	130.8	130.8	137.5	137.5	144.2	144.0
RE 35, 90 W	184	HEDL 5540	399/401	140.1	140.1	146.8	146.8	153.5	153.5
RE 35, 90 W	184	DCT 22	411	137.5	137.5	144.2	144.2	150.9	150.9
RE 35, 90 W	184	AB 28	446	155.5	155.5	162.2	162.2	168.9	168.9
RE 35, 90 W	184	HEDS 5540/AB 28	399/446	172.7	172.7	179.4	179.4	186.1	186.1
EC-max 30, 40 W	264			90.2	90.2	96.9	96.9	103.6	103.6
EC-max 30, 40 W	264	MR	392	102.4	102.4	109.1	109.1	115.8	115.8
EC-max 30, 40 W	264	HEDL 5540	403	110.8	110.8	117.5	117.5	124.2	124.2
EC-max 30, 40 W	264	AB 20	444	125.8	125.8	132.5	132.5	139.2	139.2
EC-max 30, 40 W	264	HEDL 5540/AB 20	403/444	146.4	146.4	153.1	153.1	159.8	159.8
EC-max 30, 60 W	265			112.2	112.2	118.9	118.9	125.6	125.6
EC-max 30, 60 W	265	MR	392	124.4	124.4	131.1	131.1	137.8	137.8
EC-max 30, 60 W	265	HEDL 5540	403	132.8	132.8	139.5	139.5	146.2	146.2
EC-max 30, 60 W	265	AB 20	444	147.8	147.8	154.5	154.5	161.2	161.2
EC-max 30, 60 W	265	HEDL 5540/AB 20	403/444	168.4	168.4	175.1	175.1	181.8	181.8
EC-4pole 30, 100 W	273			95.2	95.2	101.9	101.9	108.6	108.6
EC-4pole 30, 100 W	273	MR	392	107.4	107.4	114.1	114.1	120.8	120.8
EC-4pole 30, 100 W	273	HEDL 5540	404	115.8	115.8	122.5	122.5	129.2	129.2
EC-4pole 30, 100 W	273	AB 20	444	131.4	131.4	138.1	138.1	144.8	144.8
EC-4pole 30, 100 W	273	HEDL 5540/AB 20	404/444	152.2	152.2	158.9	158.9	165.6	165.6
EC-4pole 30, 200 W	275			112.2	112.2	118.9	118.9	125.6	125.6
EC-4pole 30, 200 W	275	MR	392	124.4	124.4	131.1	131.1	137.8	137.8
EC-4pole 30, 200 W	275	HEDL 5540	404	132.8	132.8	139.5	139.5	146.2	146.2
EC-4pole 30, 200 W	275	AB 20	444	148.4	148.4	155.1	155.1	161.8	161.8
EC-4pole 30, 200 W	275	HEDL 5540/AB 20	404/444	169.2	169.2	175.9	175.9	182.6	182.6
MCD EPOS, 60 W	441			168.2	168.2	174.9	174.9	181.6	181.6
MCD EPOS P, 60 W	441			168.2	168.2	174.9	174.9	181.6	181.6