

GPX 12

Planetary Gearhead Ø12 mm

NEW



Key Data	A Standard Version	C Ceramic Version
Max. transmittable power	W 2	2.4
Max. continuous torque	Nm 0.17	0.23
Max. continuous input speed	rpm 16000	16000
Ambient temperature	°C -40 ... +100	-40 ... +100
Bearing at output	Ball bearing	Ball bearing

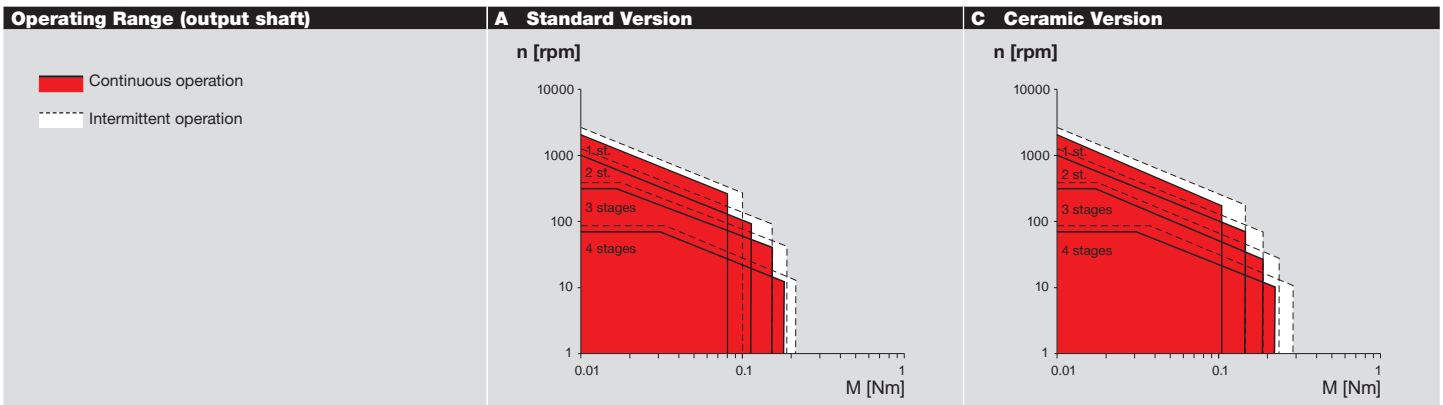

Specifications	A Standard Version				C Ceramic Version			
	1	2	3	4	1	2	3	4
Number of stages								
Max. transmittable continuous power	W 2.0	1.0	0.50	0.25	2.4	1.2	0.60	0.30
Max. transmittable intermittent power	W 2.5	1.25	0.65	0.30	3.0	1.50	0.80	0.40
Max. continuous torque	Nm 0.08	0.11	0.14	0.17	0.11	0.15	0.19	0.23
Max. intermittent torque	Nm 0.10	0.14	0.18	0.21	0.15	0.19	0.24	0.29
Max. continuous input speed	rpm 16000	16000	16000	16000	16000	16000	16000	16000
Max. intermittent input speed	rpm 20000	20000	20000	20000	20000	20000	20000	20000
Max. efficiency	% 90	80	75	65	90	80	75	65
Average backlash no load	° 1.2	1.5	1.8	2.1	1.2	1.5	1.8	2.1
Max. axial load (dynamic)	N 20	20	20	20	20	20	20	20
Max. radial load, 5 mm from flange	N 30	35	50	50	30	35	50	50
Gearhead length L1	mm 15.5	20.4	25.2	30.1	15.5	20.4	25.2	30.1
Weight	g 11	14	17	19	11	14	17	19

Configuration	A Standard Version				C Ceramic Version			
	1	2	3	4	1	2	3	4
Number of stages								
Reduction	X:1 3.9, 5.3	16, 21, 26, 28, 35	62, 83, 103, 111, 138, 150, 172, 186, 231	243, 326, 406, 439, 546, 590, 679, 734, 794, 913, 987, 1135, 1227, 1526	3.9, 5.3	16, 21, 26, 28, 35	62, 83, 103, 111, 138, 150, 172, 186, 231	243, 326, 406, 439, 546, 590, 679, 734, 794, 913, 987, 1135, 1227, 1526
Version	Standard/ceramic version/noise reduced/reduced backlash/high power							
Flange	Standard flange/configurable flange							
Shaft	Length/flat face							

maxon Modular System	Page	Dimensions
maxon DC motor	Number of stages	
DCX 12 S	1-4	66
DCX 12 L	1-4	67

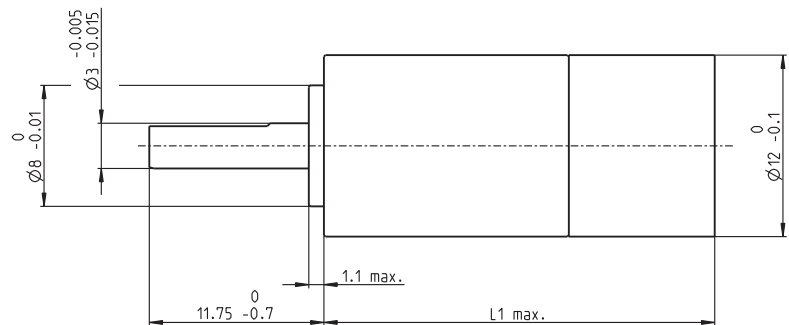

xdrives.maxonmotor.com