

GPX 19 SPEED

Planetary Gearhead Ø19 mm

Sterilizable

NEW



maxon X drives

Key Data		Without shaft seal*	With shaft seal*
Max. transmittable power	W	62 (10.4)	62 (10.4)
Max. continuous torque	Nm	0.2 (0.36)	0.2 (0.36)
Max. continuous input speed	rpm	45000	45000
Ambient temperature	°C	-10 ... +135	-10 ... +135
Bearing at output		Ball bearing	Ball bearing

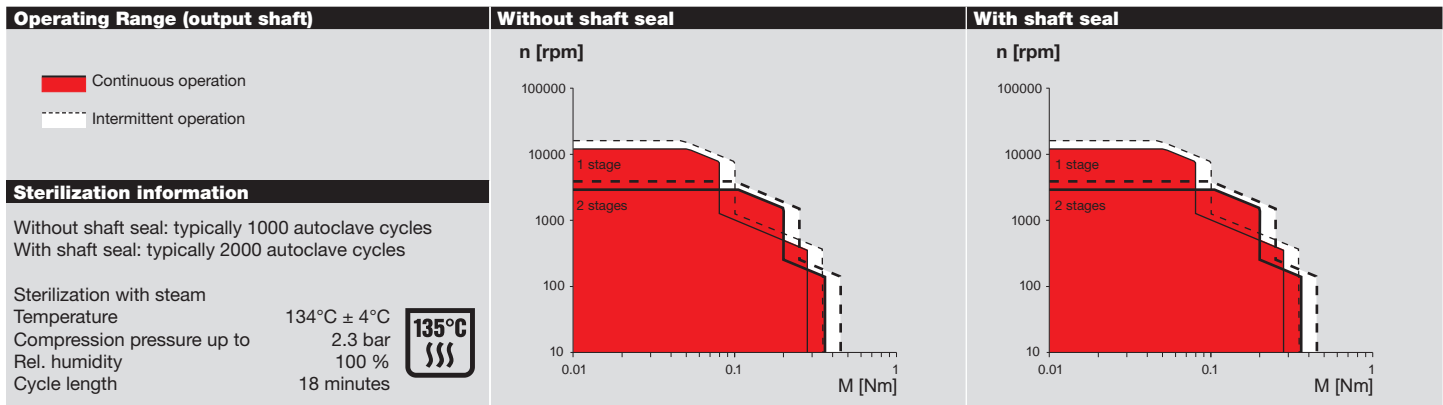

Specifications		Without shaft seal*		With shaft seal*	
		1	2	1	2
Number of stages					
Max. transmittable continuous power	W	62 (10.4)	31 (5.2)	62 (10.4)	31 (5.2)
Max. transmittable intermittent power	W	77 (13)	38 (6.5)	77 (13)	38 (6.5)
Max. continuous torque	Nm	0.08 (0.28)	0.2 (0.36)	0.08 (0.28)	0.2 (0.36)
Max. intermittent torque	Nm	0.1 (0.35)	0.25 (0.45)	0.1 (0.35)	0.25 (0.45)
Max. continuous input speed	rpm	45000	45000	45000	45000
Max. intermittent input speed	rpm	60000	60000	60000	60000
Max. efficiency	%	85	80	85	80
Average backlash no load	°	1.4	1.6	1.4	1.6
Max. axial load (dynamic)	N	40.0	40.0	40.0	40.0
Max. radial load, 5 mm from flange	N	50.0	85.0	35.0	55.0
Gearhead length L1	mm	31.4	40.3	39.20	48.10
Weight	g	41	54	56	69

Configuration		Without shaft seal		With shaft seal	
		1	2	1	2
Number of stages					
Reduction	X:1	3.9, 5.3, 6.6	16, 21, 26, 28, 35, 44	3.9, 5.3, 6.6	16, 21, 26, 28, 35, 44
Version		Without shaft seal/With shaft seal			
Flange		Standard flange			
Shaft		Length/flat face/cross hole			

maxon Modular System	Page	Dimensions
maxon EC motor	Number of stages	
ECX SPEED 19 M	1-2	100-101
ECX SPEED 19 L	1-2	102-103

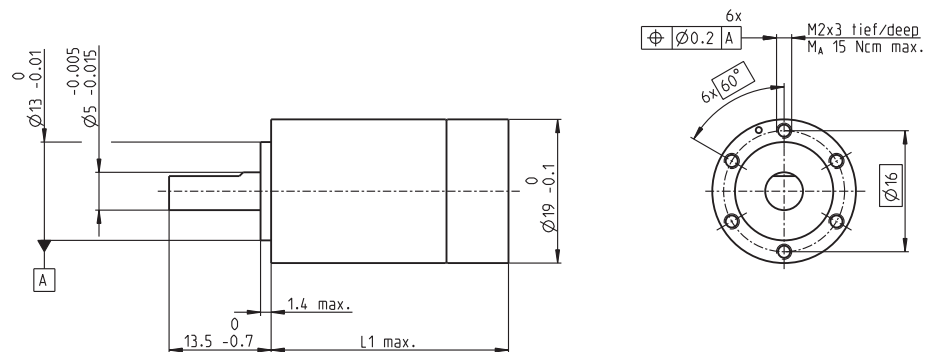

xdrives.maxonmotor.com

*Values in parentheses apply in case of reduced speed (according to diagram).